

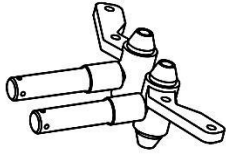

SGC Golf Cart  
All-terrain Suspension  
for EZGO TXT 01 and up (6 inches)



# INSTALLATION INSTRUCTIONS



1. Spindle

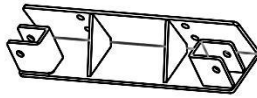

2. Top shock mount

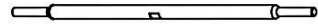

3. Tie rod

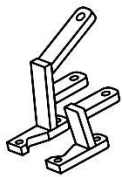

4. Steering riser

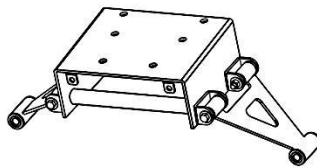

5. A-arm base

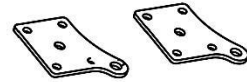

6. Rear shock plate



7. SGC plate

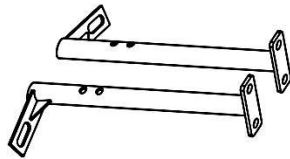

8. Main bracket A

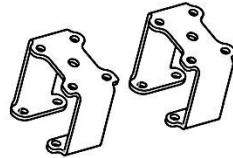

9. Rear riser



10. Rack and pinion spacers

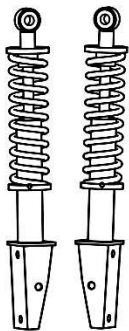

11. Coil-over shock

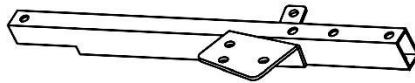

Main bracket B (Driver side)

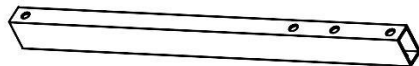

Main bracket C (Passenger side)

12. Main bracket B and C

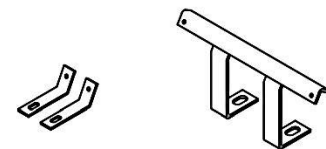

lower

upper

13. Front bumper brackets

## INSTALLATION INSTRUCTIONS

Bag#	Application	Spec		Qty
1	A-arm to Coilover Shock	Hex Bolt	1/2-13*4	2
		Lock Nut	1/2-13	2
		Flat Washer	1/2	4
2	Main bracket A to cart frame	Hex Bolt	3/8-16 *1-1/2	2
		Lock Nut	3/8-16	2
		Flat Washer	3/8	4
		Rubber Spacer		2
3	Top shock mount to Coil over shock	Hex Bolt	3/8-16*2-1/4	2
		Lock Nut	3/8-16	2
		Flat Washer	3/8	4
4	Steering Riser	Hex Bolt	3/8-16*1-5/8	4
		Lock Nut	3/8-16	4
		Flat Washer	3/8	8
5	Rack and pinion to Main bracket B	Hex Bolt	7/16-14*2-3/4	3
		Lock Nut	7/16-14	3
		Flat Washer	7/16	6
6	Main bracket C to cart	Hex Bolt	7/16-14*3-1/4	3
		Lock Nut	7/16-14	3
		Flat Washer	7/16	6
7	Main bracket B to cart	Hex Bolt	7/16-14*3	3
		Lock Nut	7/16-14	3
		Flat Washer	7/16	6
8	Main bracket A to Main bracket B and C	Hex Bolt	1/2-13*3-1/4	6
		Lock Nut	1/2-13	6
		Flat Washer	1/2	12
9	SGC Plate	Hex Bolt	3/8-16*3/4	2
		Lock Nut	3/8-16	2
		Flat Washer	3/8	4
10	Main bracket A to Top shock mount	Hex Bolt	3/8-16 *2	4
		Lock Nut	3/8-16	4
		Flat Washer	3/8	8
11	Factory front bumper	Hex Bolt	1/4-20 *1/2	6
		Flat Washer	1/4	4
		Flat Washer	M8	2
		Spring Washer	M8	2
12	Spindle	Egg neck Bolt	1/2-20*2	4
13	Heim joint	Heim Joint	1/2-20*2-3/16	4
		Hex Bolt	1/2-20	8
		Flat Washer	1/2	8
14	φ25.4 Axle	Pin	4*35	2
	Rack and Pinion	Pin	2.5 × 20	3
15	Rear Riser	Hex Bolt	3/8-16*1-1/4	8
		Lock Nut	3/8-16	8
		Flat Washer	3/8	16
16	Front cowl	Rivet	4.8*25	15
17		Rivet tool		1

# INSTALLATION INSTRUCTIONS

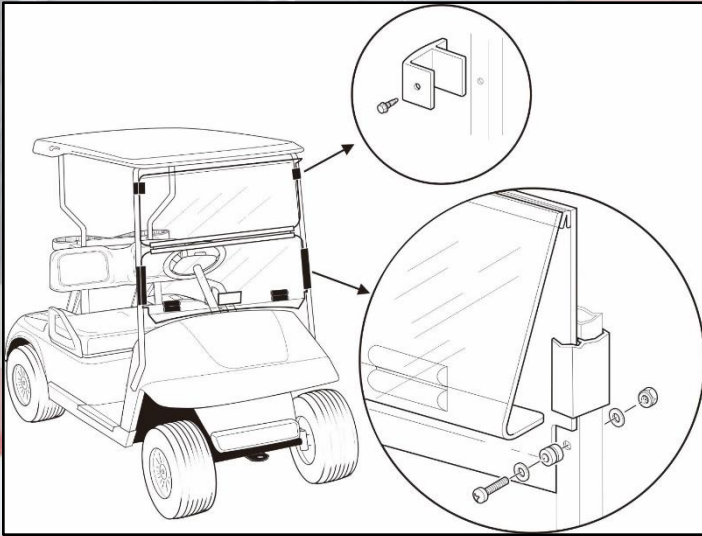

1. Remove windshield, retain hardware.

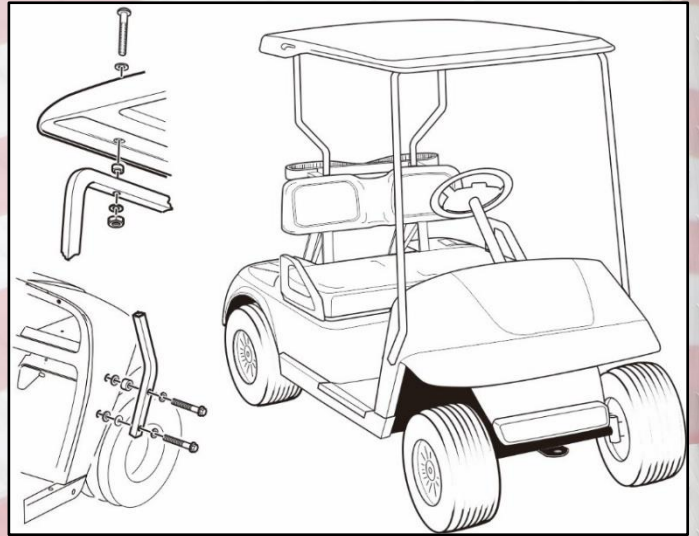

2. Remove roof canopy and roof struts. Retain hardware.

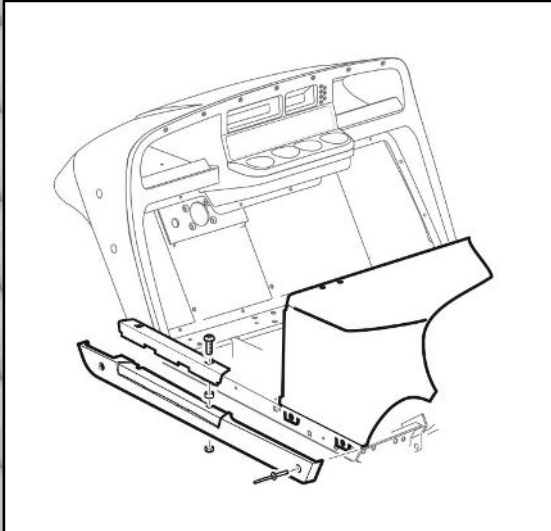

3. Remove rocker panel.

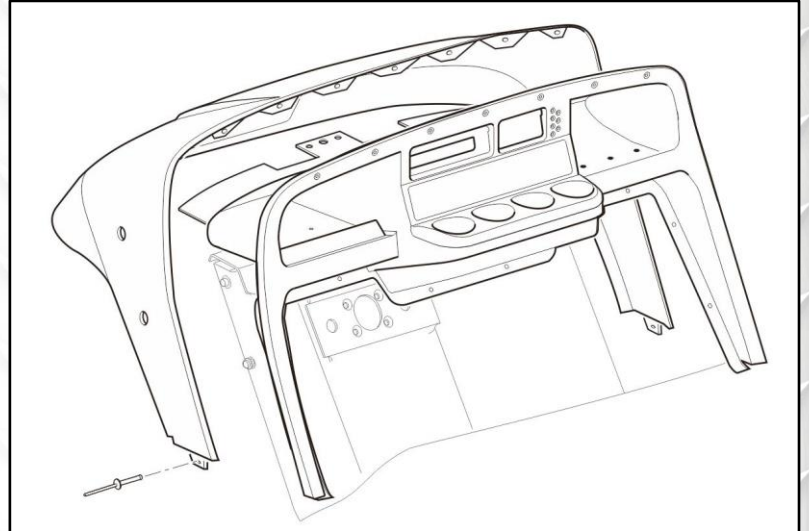

4. Remove front cowl and disregard rivets.

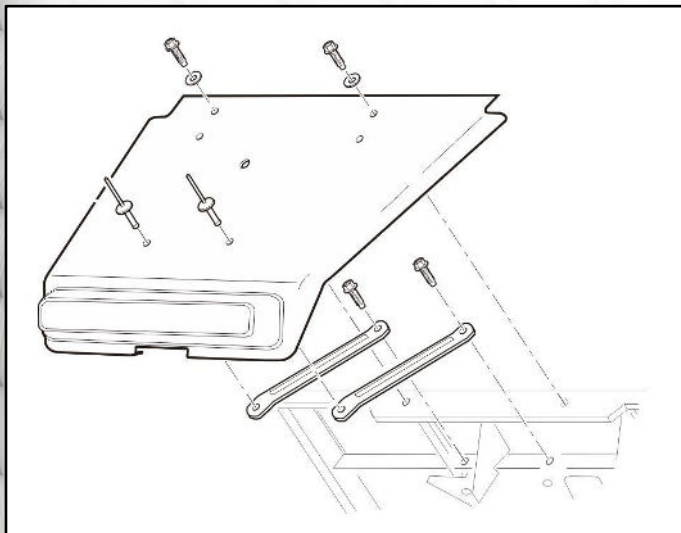

5. Remove front shock cover and supporting bracket.

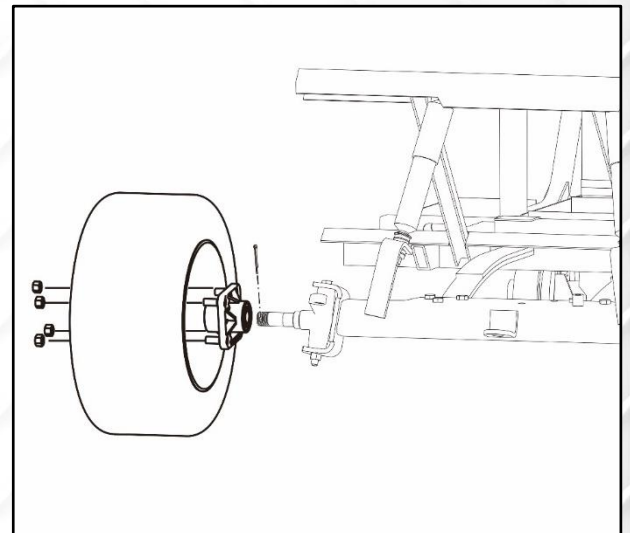

6. Remove front wheels and hubs.

## INSTALLATION INSTRUCTIONS

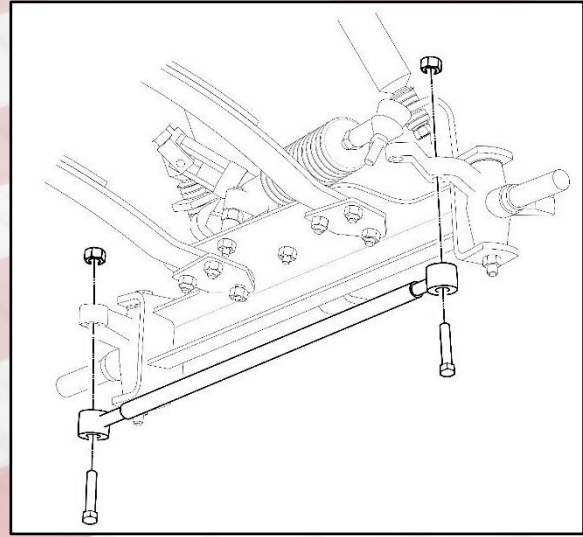
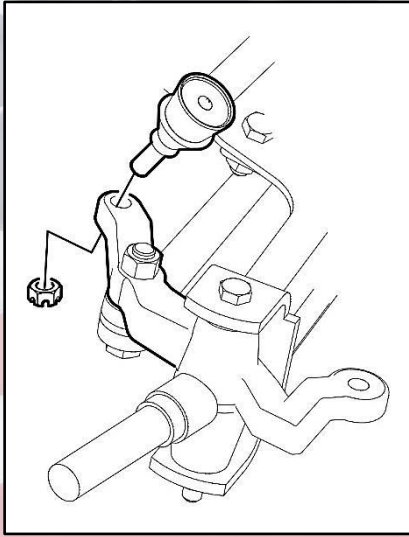

7. Disconnect rack and pinion from spindle. Disconnect tie rod from spindles.

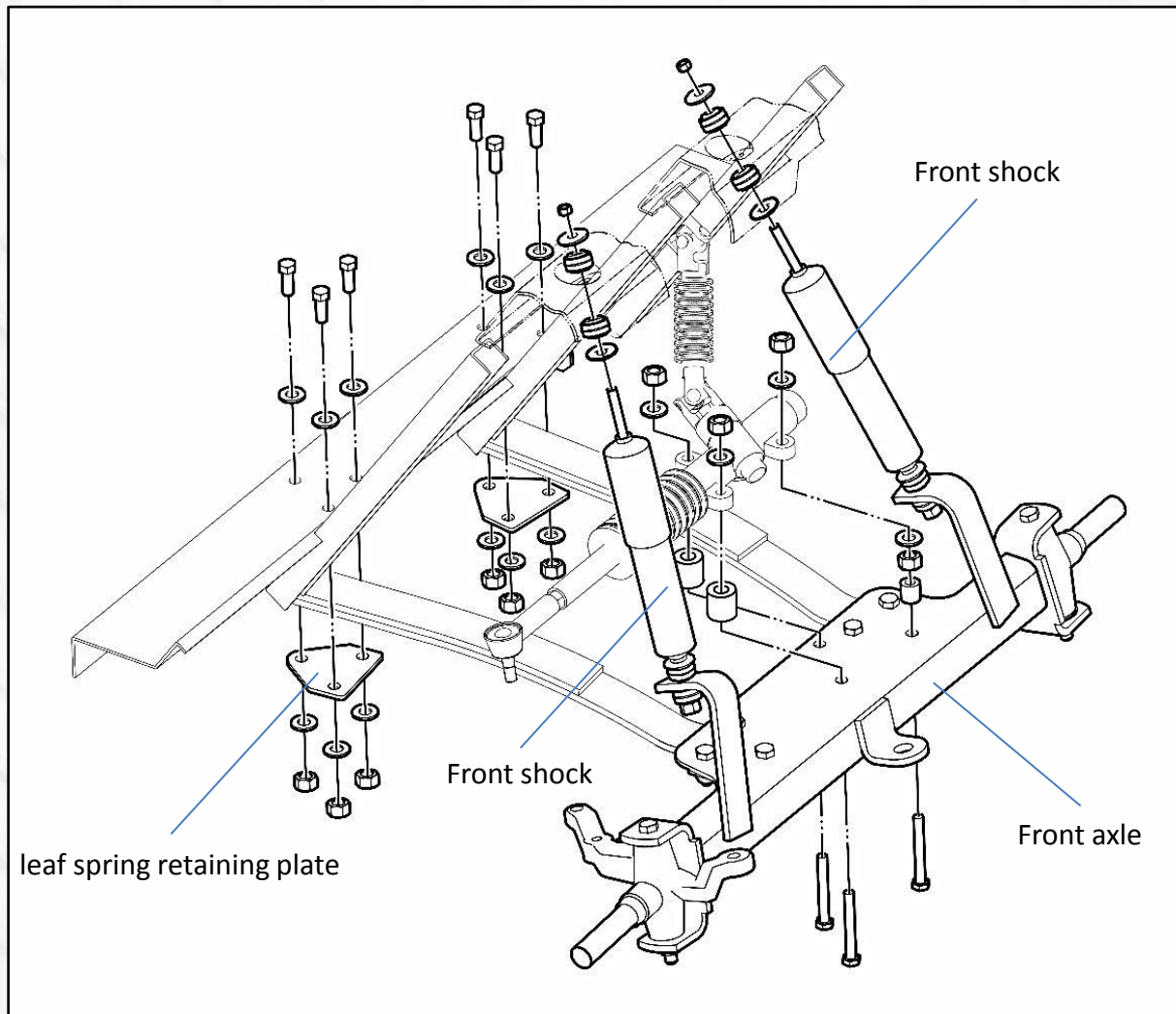

8. Remove front axle, front shock, leaf spring retaining plate and front leaf spring from cart.

## INSTALLATION INSTRUCTIONS

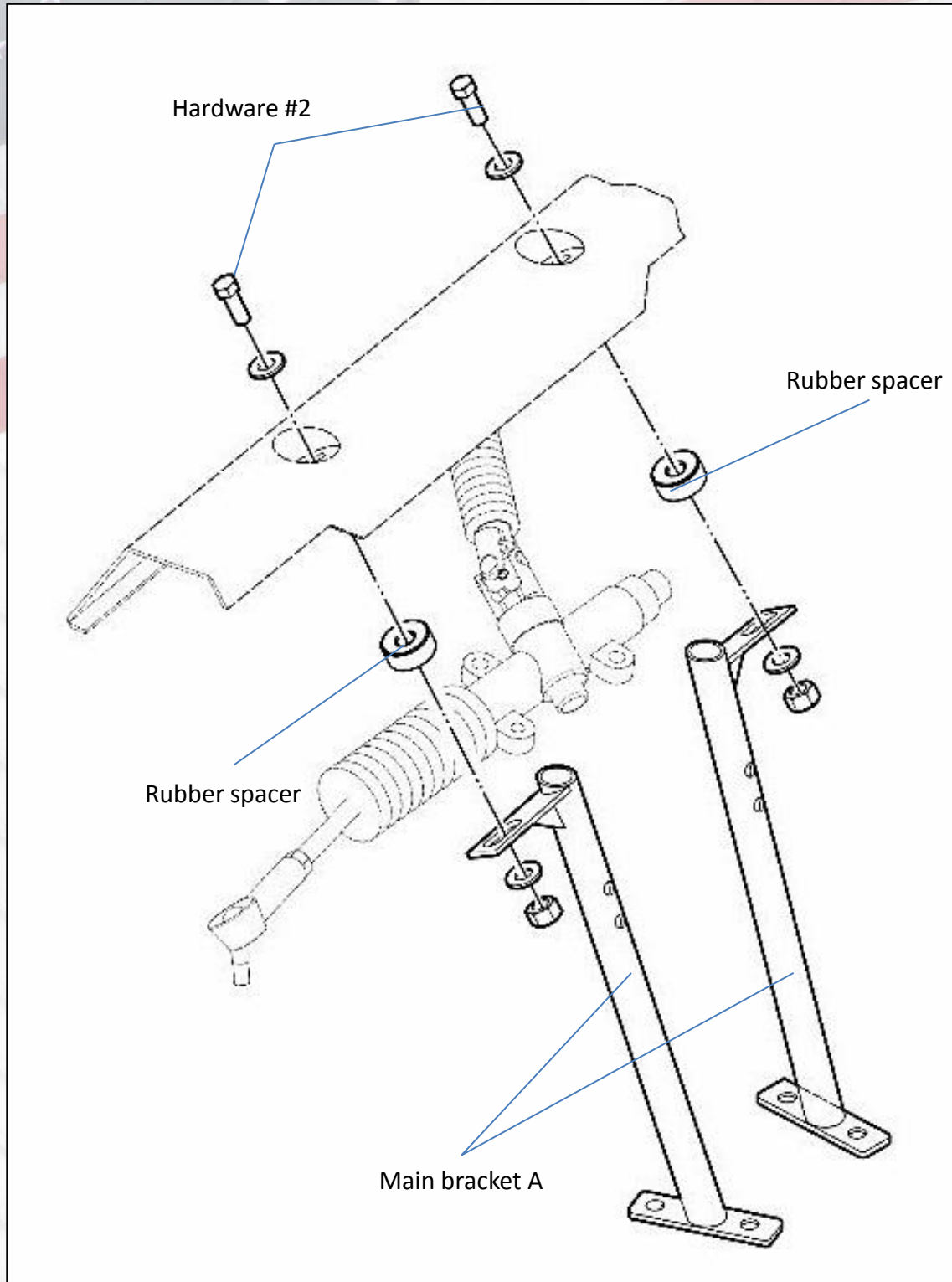

9. Install main bracket A to cart frame using hardware #2. Spacers will be used as shown in the picture.

## INSTALLATION INSTRUCTIONS

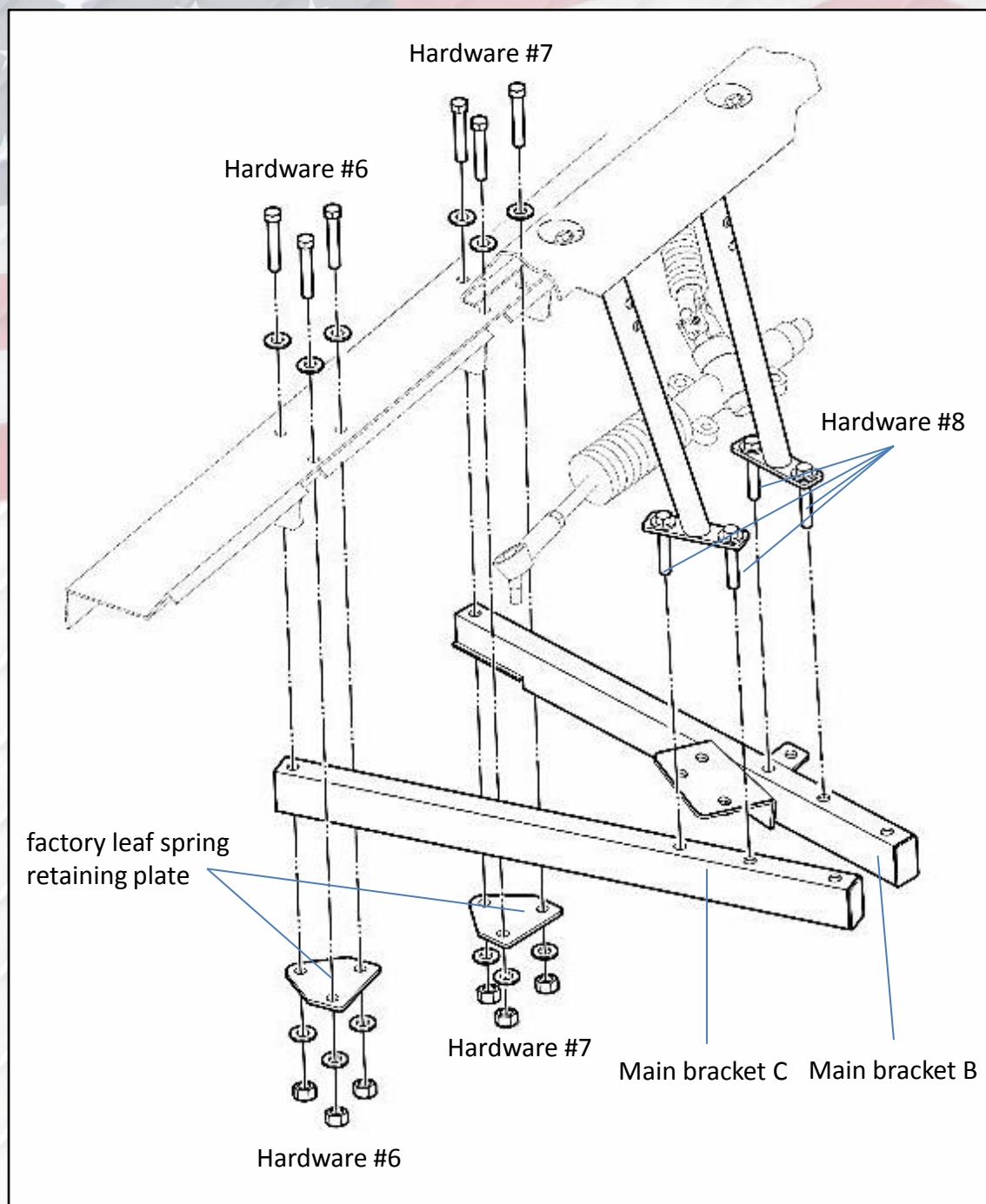

10. Put through three bolts and washers from hardware #7 on driver side of cart frame first. Install factory leaf spring retaining plate and main bracket B together by tightening the nut from below the retaining plate.

Attach main bracket A to main bracket B using hardware #8. Leave bolts loose.

Repeat on the passenger side using bolts from hardware #6. Install factory leaf spring retaining plate and main bracket C together by tightening the nut from below the retaining plate.

Attach main bracket A to main bracket C using hardware #8. Leave bolts loose.



## INSTALLATION INSTRUCTIONS

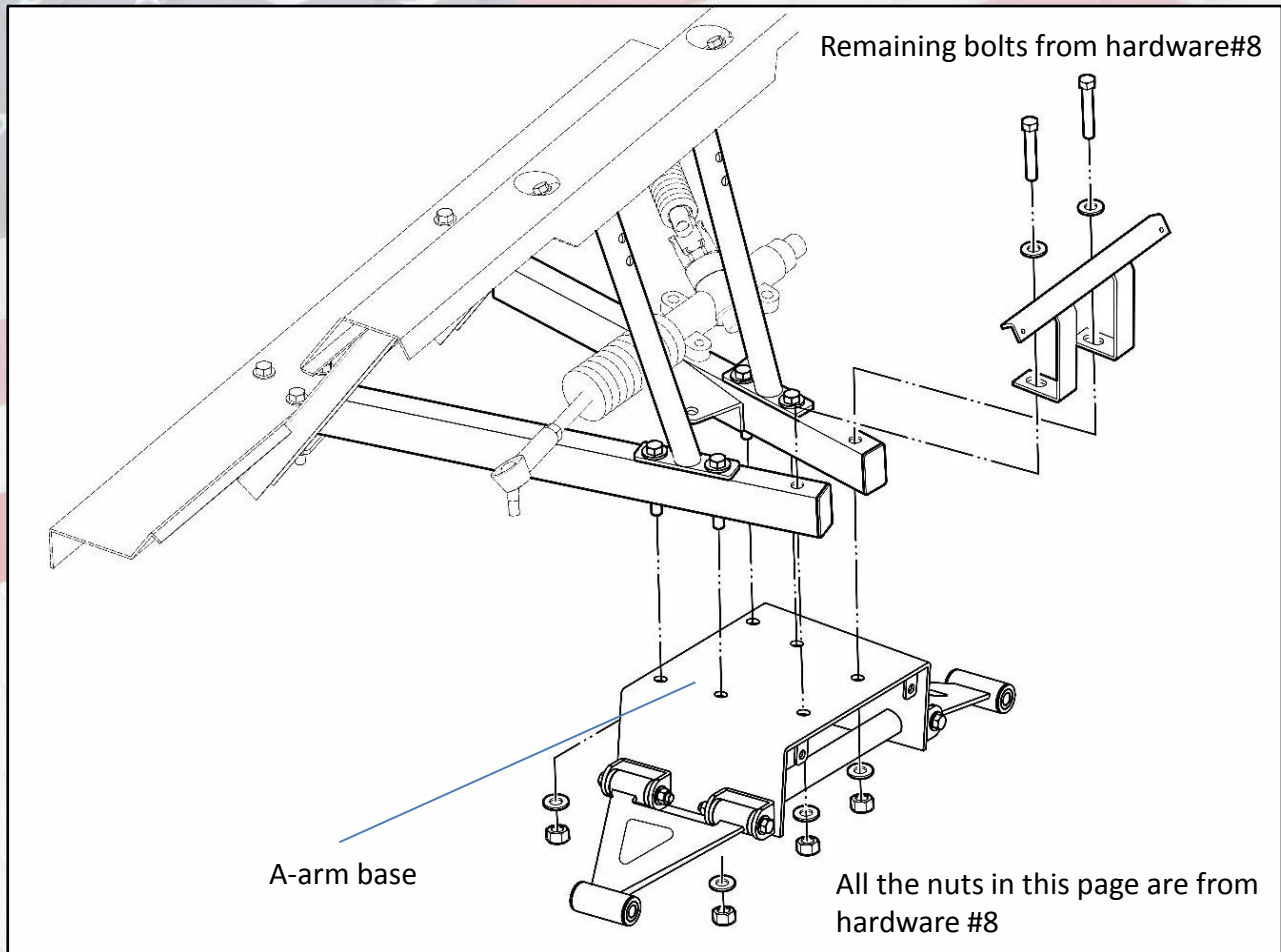

11. Install A-arm base to loose bolts from last step and fasten the nut from inside the base using hardware #8.

Then install front bumper bracket to main frame B and C using remaining bolts/nuts/washers from hardware #8. The bolts will go all the way down the a-arm base.

## INSTALLATION INSTRUCTIONS

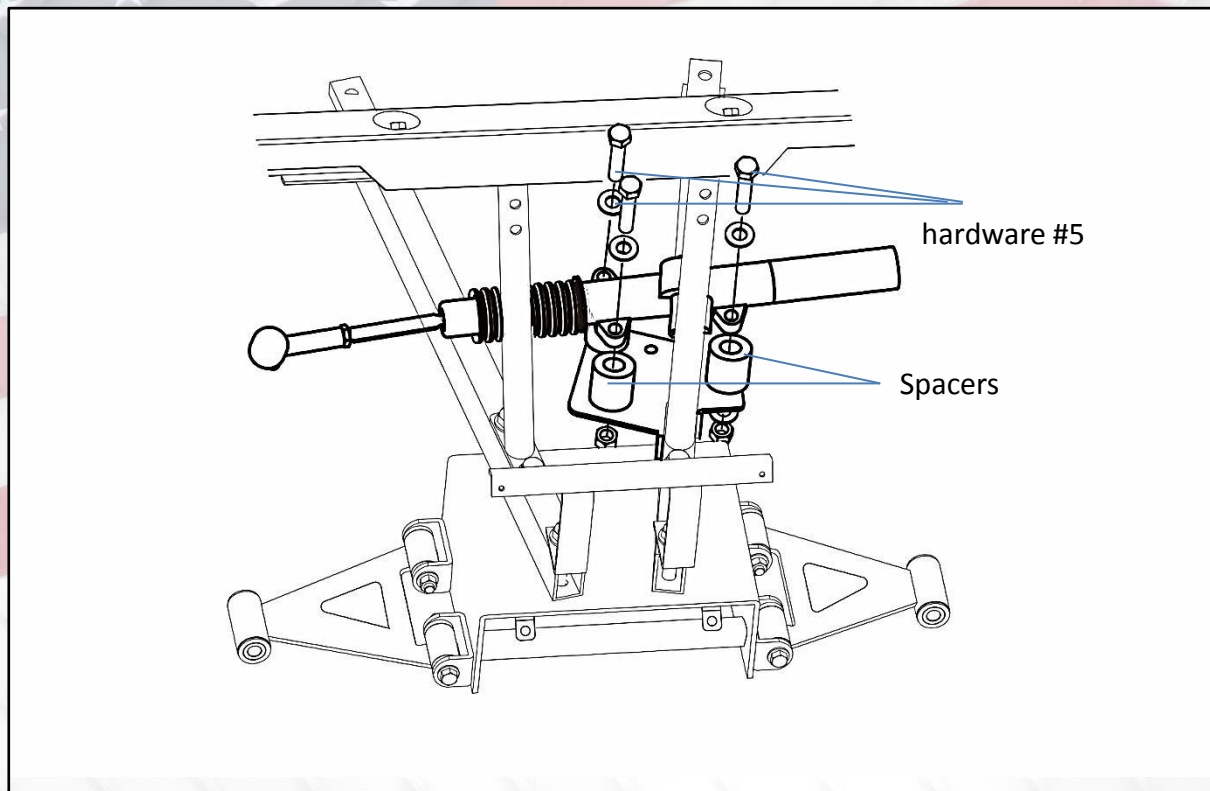

12. Install rack and pinion to main bracket B using three supplied spacers and hardware #5.

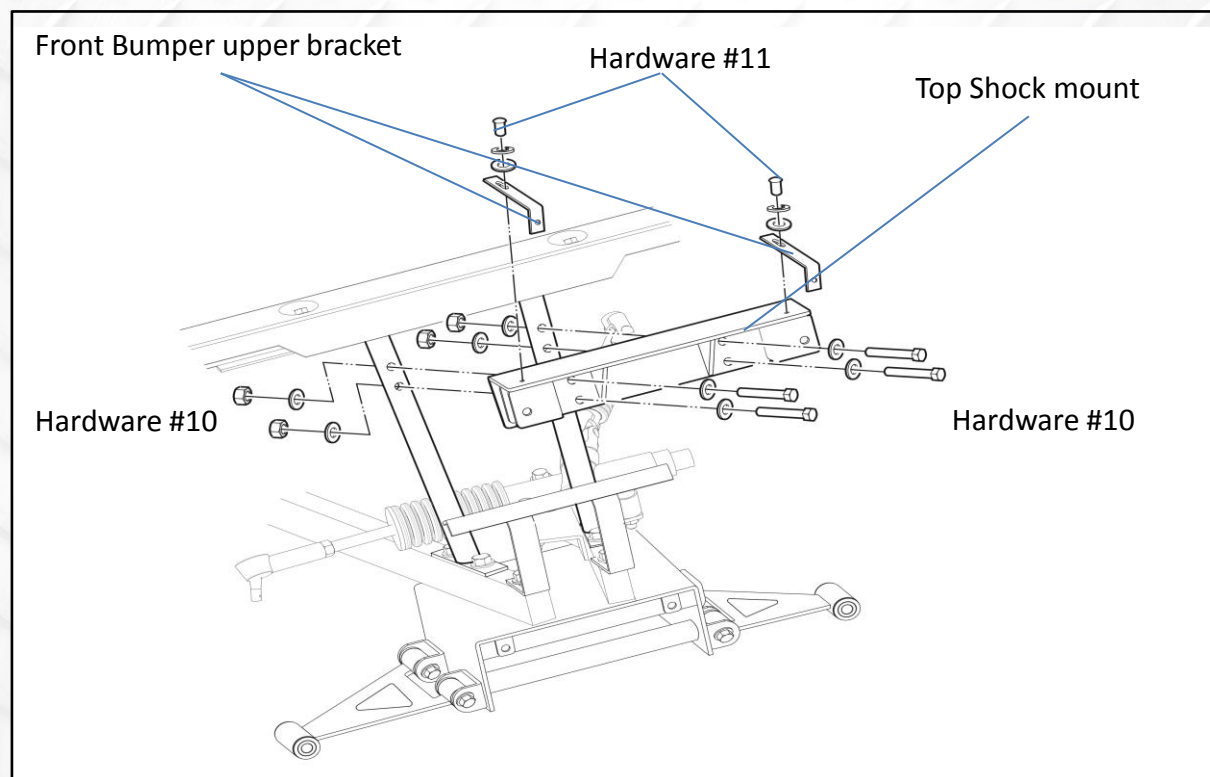

13. Attach top shock mount to main bracket A using hardware #10. install front bumper upper bracket to top shock mount using bolts/M8 spring washer/M8 flat washer from hardware #11.

## INSTALLATION INSTRUCTIONS

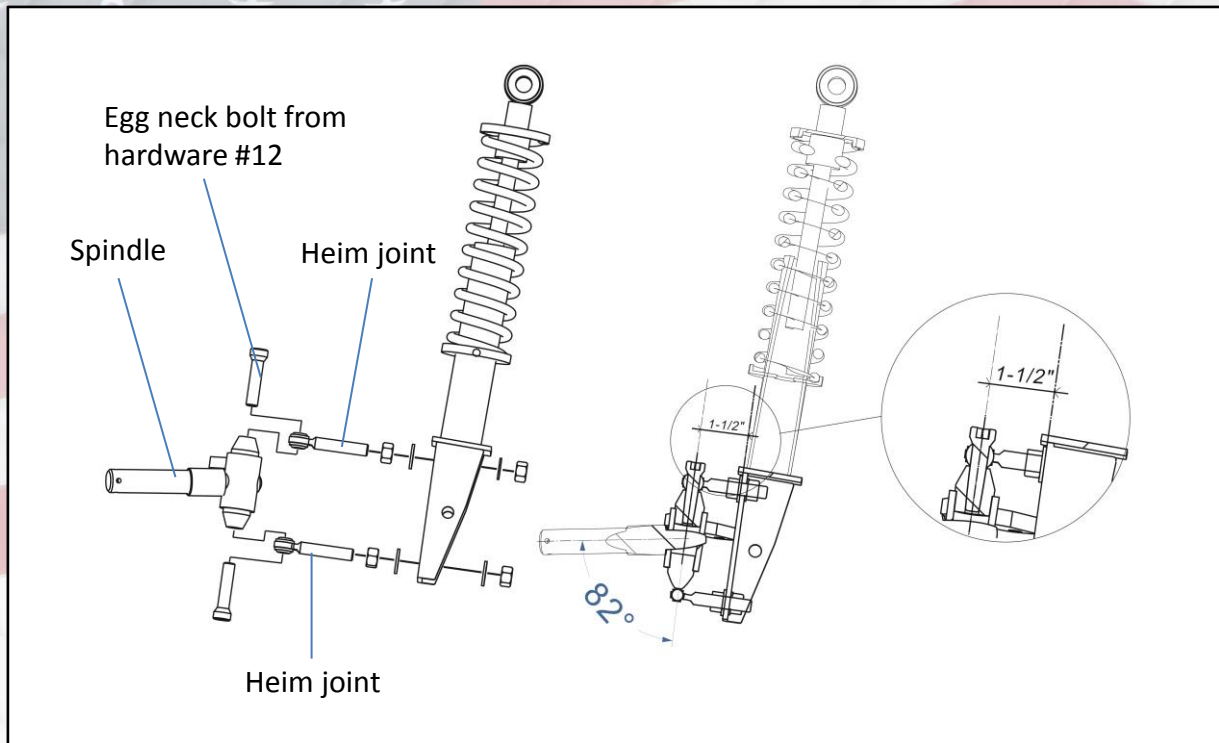

14. Install heim joint to supplied coil-over shock using hardware #13. Suggested position for heim joint is indicated as 1-1/2" away from shock. Then install supplied spindle between the heim joints using hardware #12.

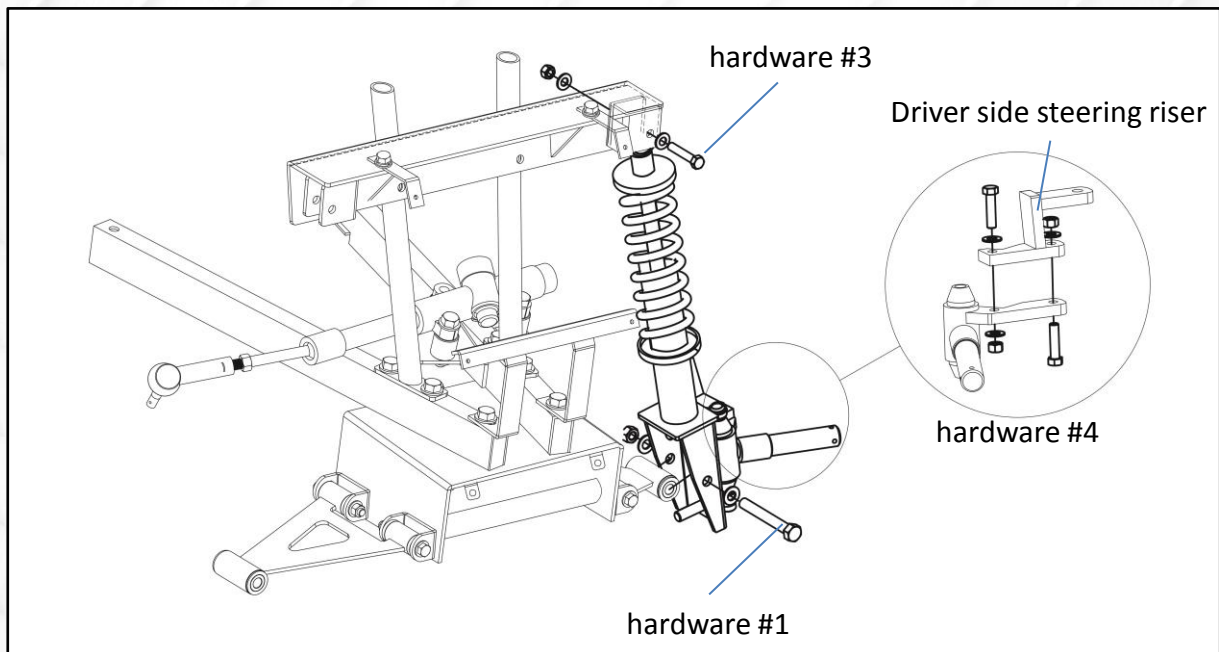

15. Install Spindle & Coil-over shock assembly to top shock mount on driver side using hardware #3. Attach lower end of shocks to A-arm using hardware #1.

Install driver side steering riser on spindle using hardware #4.

# INSTALLATION INSTRUCTIONS

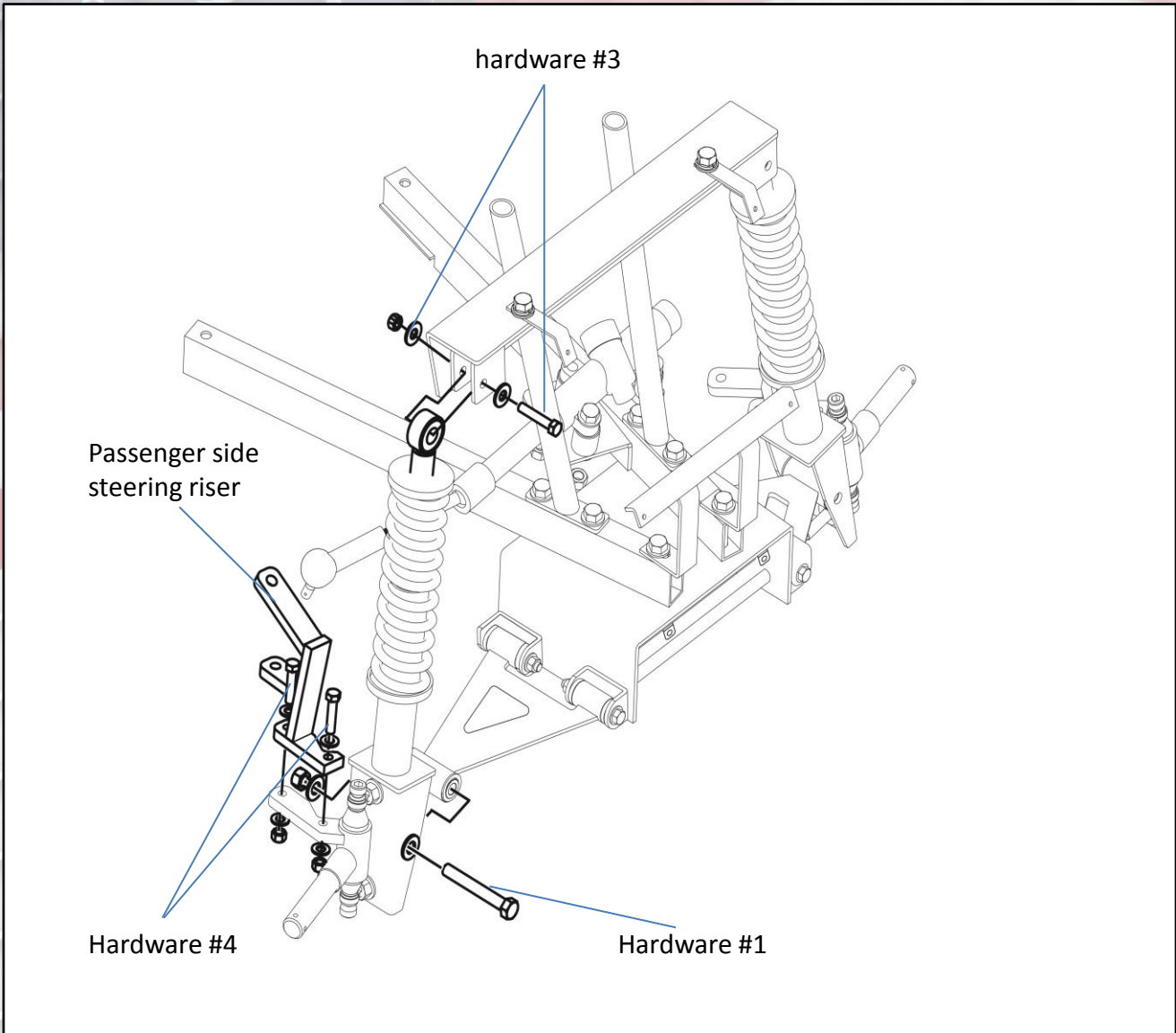

16. Repeat previous step on passenger side.

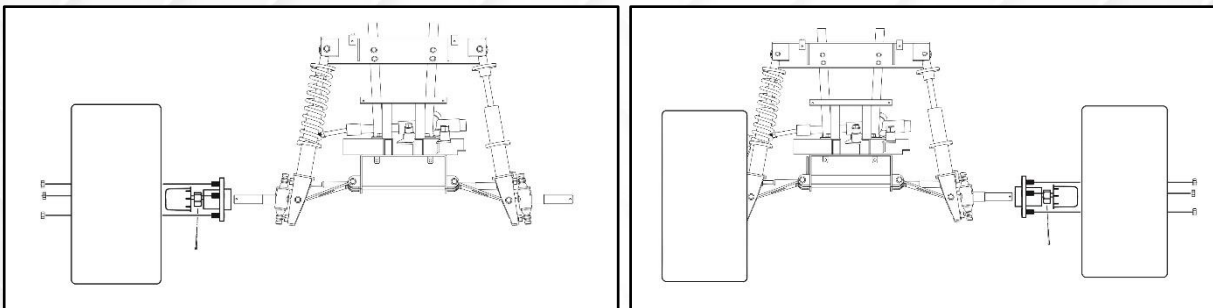

17. Reinstall front hubs and wheels on cart. Let us move to rear and get back to front later.

## INSTALLATION INSTRUCTIONS

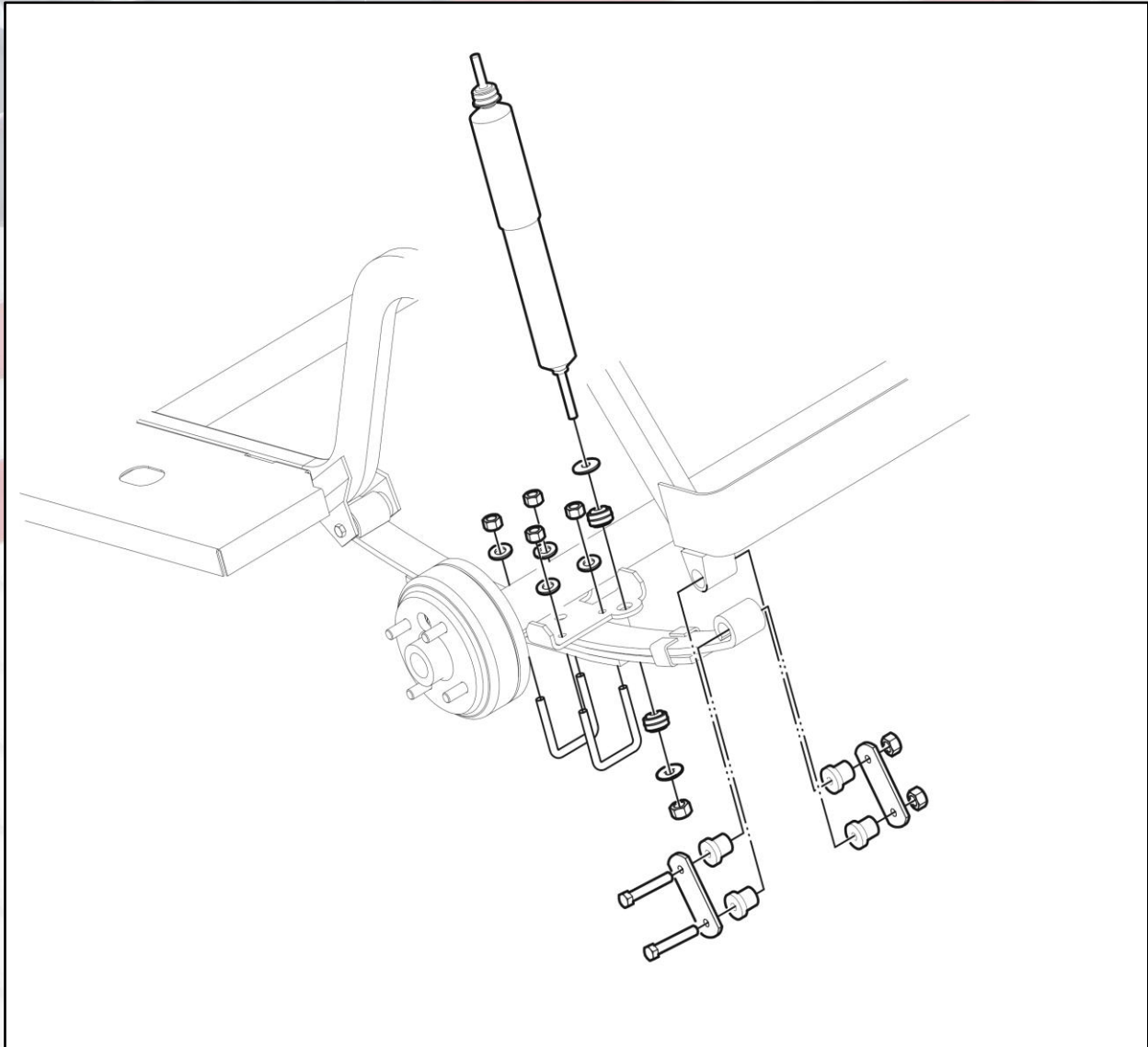

18. Jack up the rear end of the cart and place jack stands on the frame in front of the springs. Place a car jack under the rear-end housing. You will be installing larger wheels and tires so raise the cart high enough to accommodate the additional height.

19. Remove the wheels and tires. Unbolt the bottom of the shocks. Clean and lubricate bolts for later use.

20. Unbolt the rear leaf springs from under the rear end. Save the front and rear leaf spring bolts for reinstallation of the leaf springs. Using the car jack lower the rear end of the cart.

## INSTALLATION INSTRUCTIONS

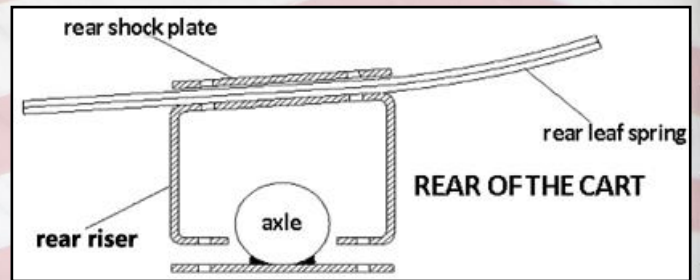
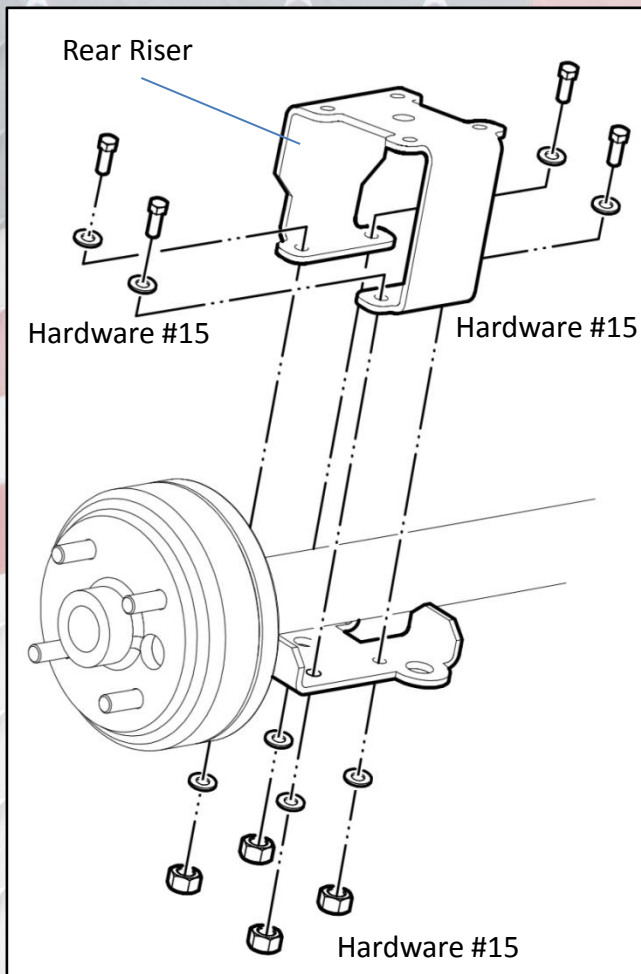

21. Sit Rear Riser on top of the rear axle as shown using hardware #15.

NOTE: Rear riser is directional.

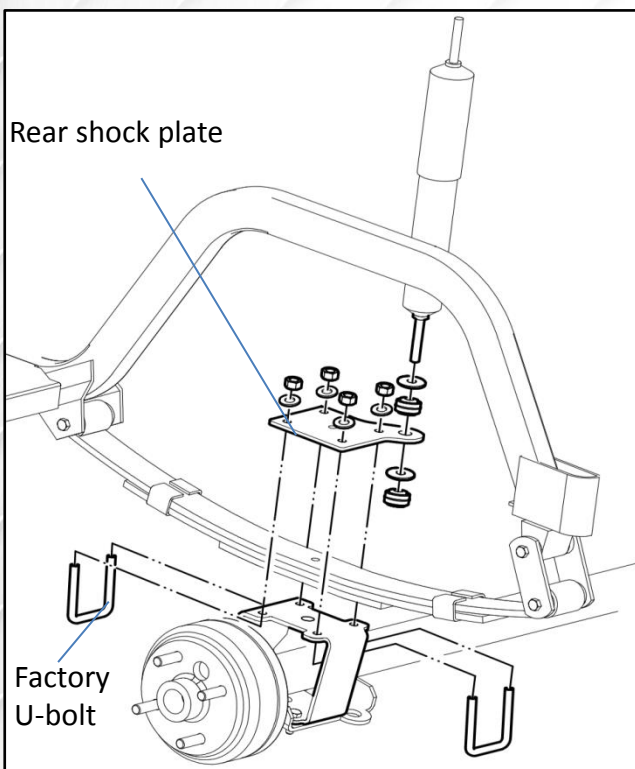

22. Place the leaf spring on top of the rear riser and loosely mount the front of the leaf springs to the stock front leaf spring mount using the stock hardware.

23. Place rear shock plate on top of the leaf spring with the shock mount holes facing the rear of the cart and towards the center.

24. Using the stock leaf spring bolts and nuts, bolt the rear leaf spring to the stock rear leaf spring mount. Attach the bottom of the shocks to rear shock plate using the stock nuts and bolts.

## INSTALLATION INSTRUCTIONS

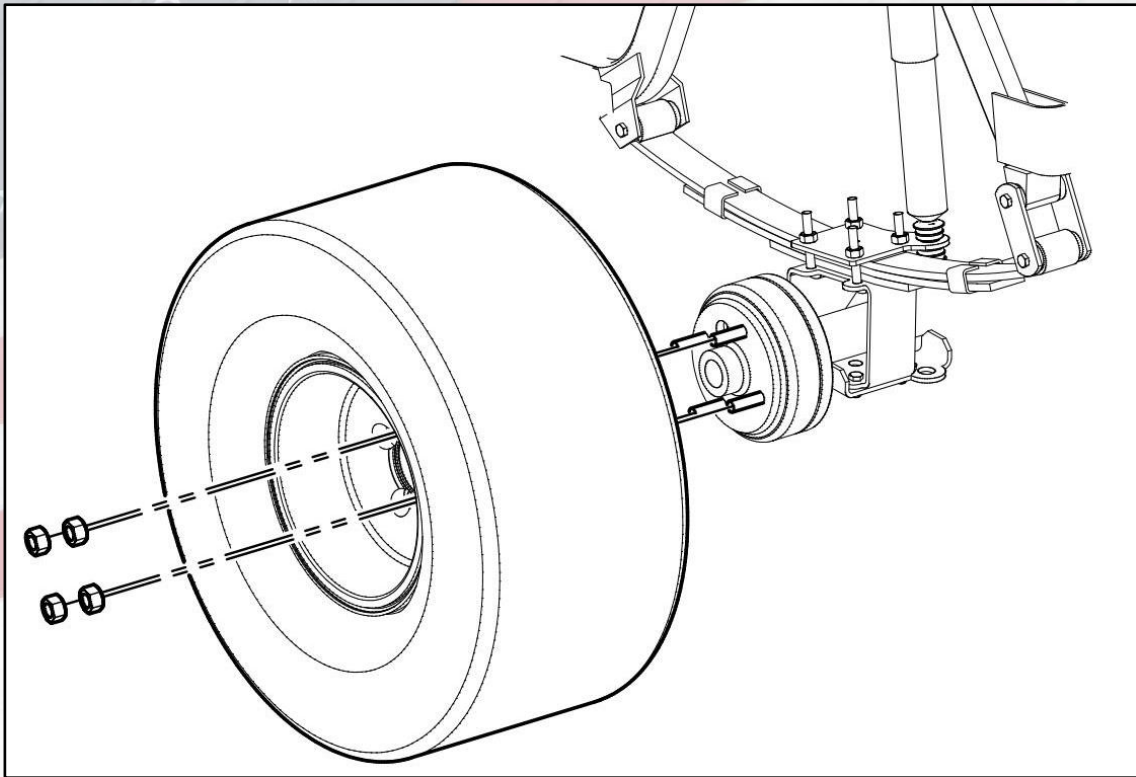

25. Use wire ties to fasten the brake cable to either the underside of the springs or the frame.

26. Securely tighten all nuts/bolts. Install recommended wheel and tire size 22 x 11 x 10 wheels and tires with a 3 x 5" offset for maximum performance. NOTE: Your stock wheels and tires will work but are **not** recommended!

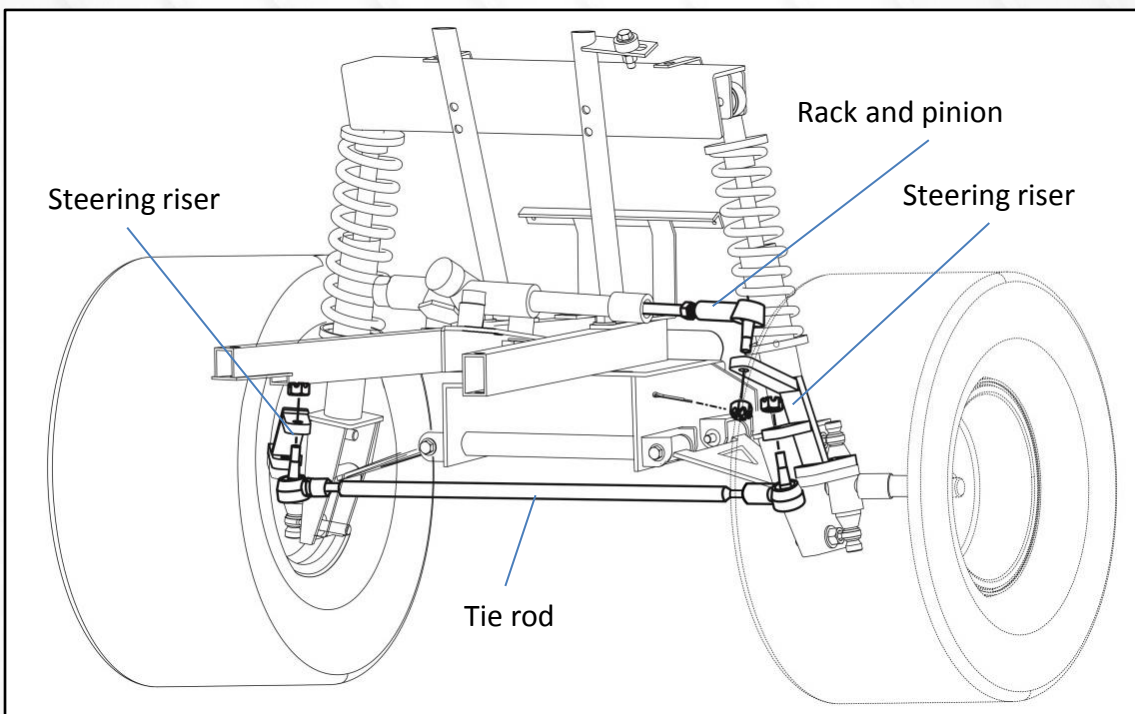

27. Let us turn back to front of cart. Align front wheels so the rack and pinion stands in the center. Then attach tie rod to steering risers. Attach rack and pinion to driver side steering risers. All hardware used in this step are factory hardware. Addition pins for rack and pinion are provided in hardware #14 if factory pins are rust.

## INSTALLATION INSTRUCTIONS

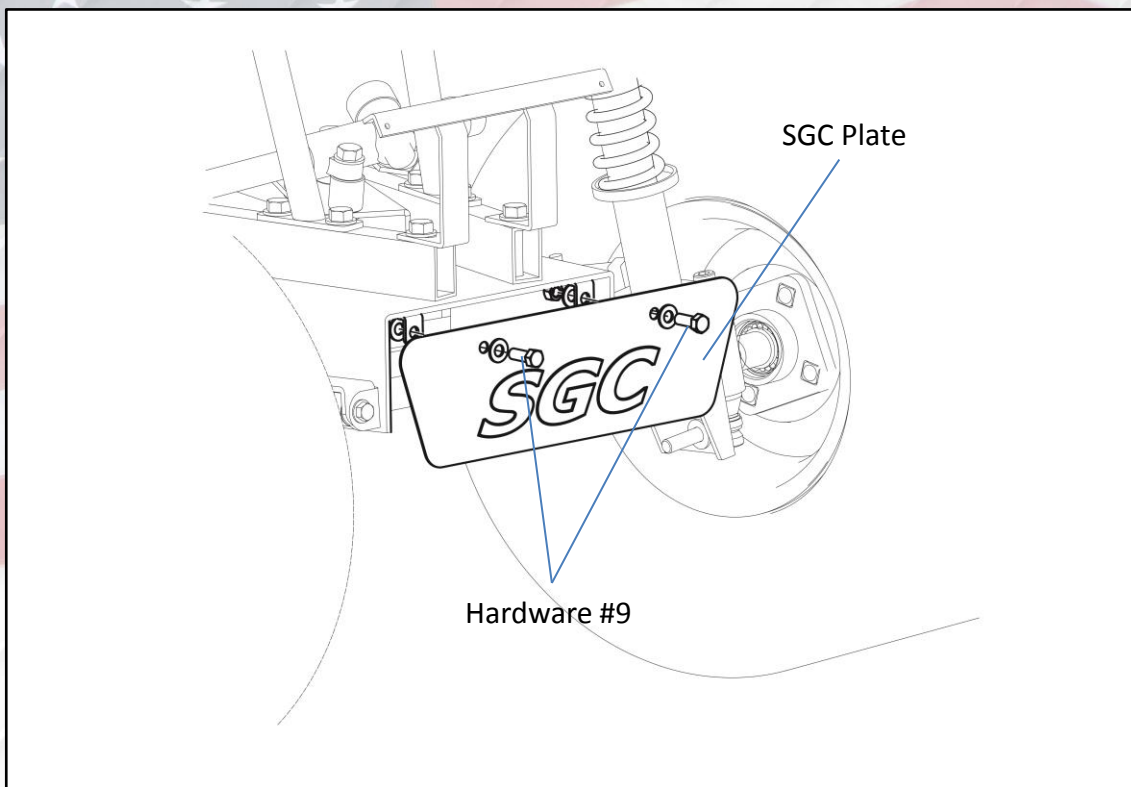

28. Attach SGC plate to mounting parts in A-arm base using hardware #9.

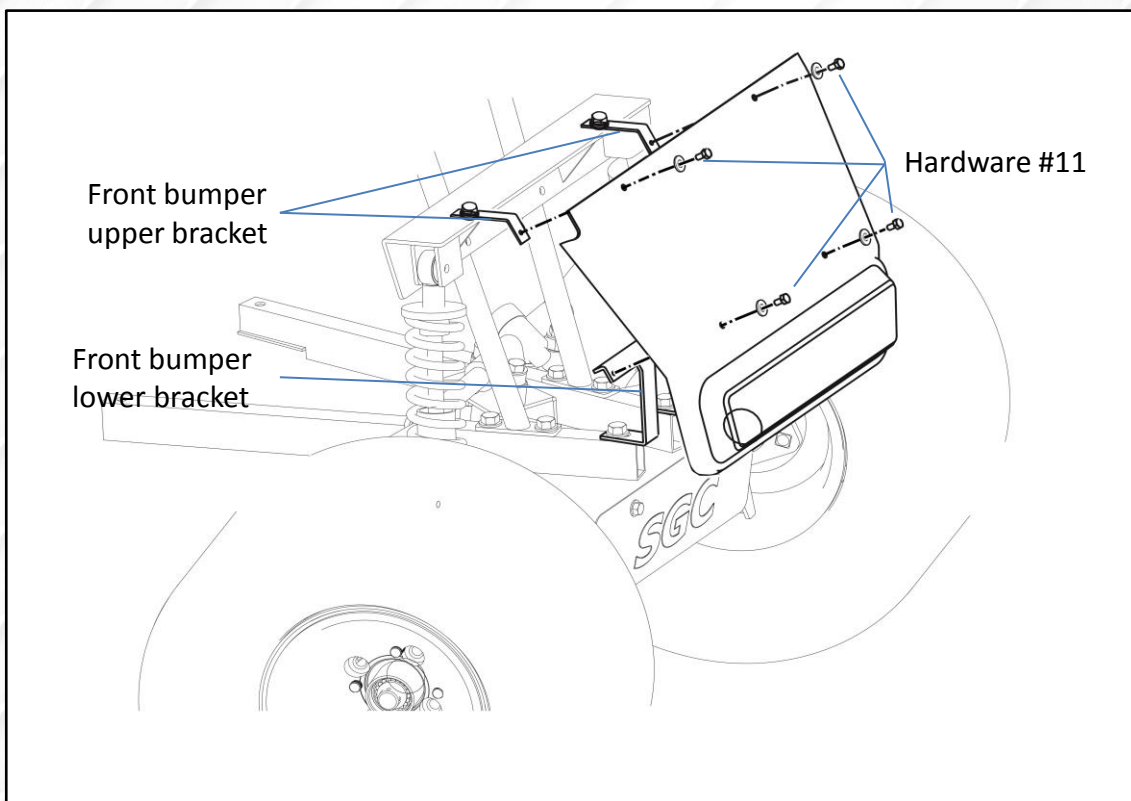

29. Attach factory front bumper to mounting brackets as shown using remaining hardware #11.



## INSTALLATION INSTRUCTIONS

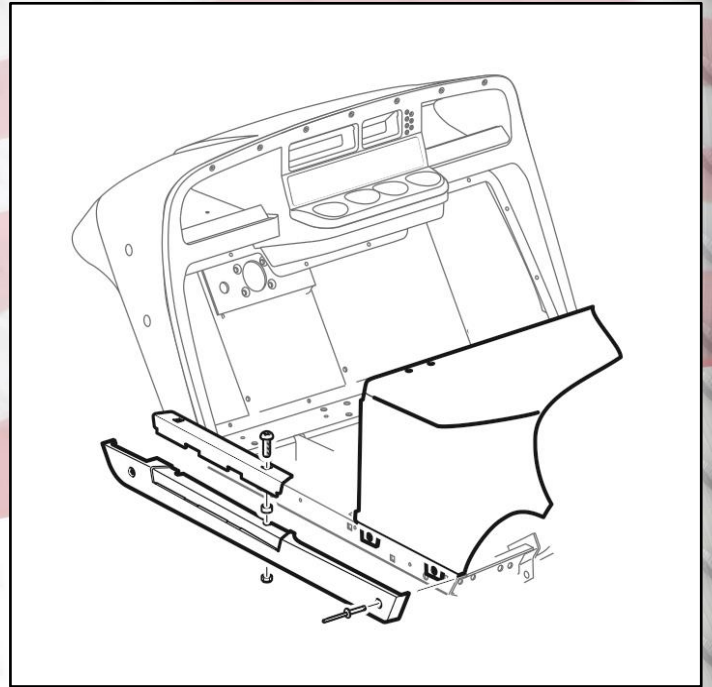
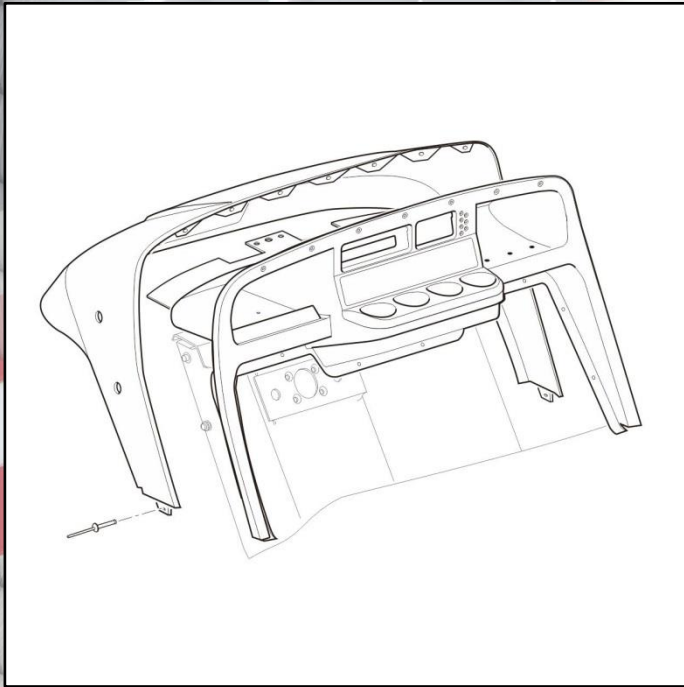

30. Re-attach front cowl to cart using supplied rivets. Re-attach rocker panels back to cart using factory hardware.

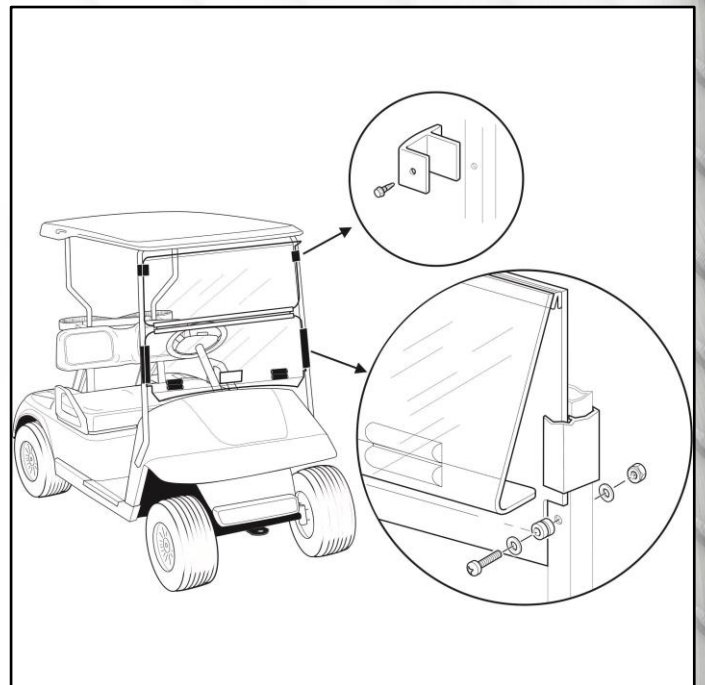
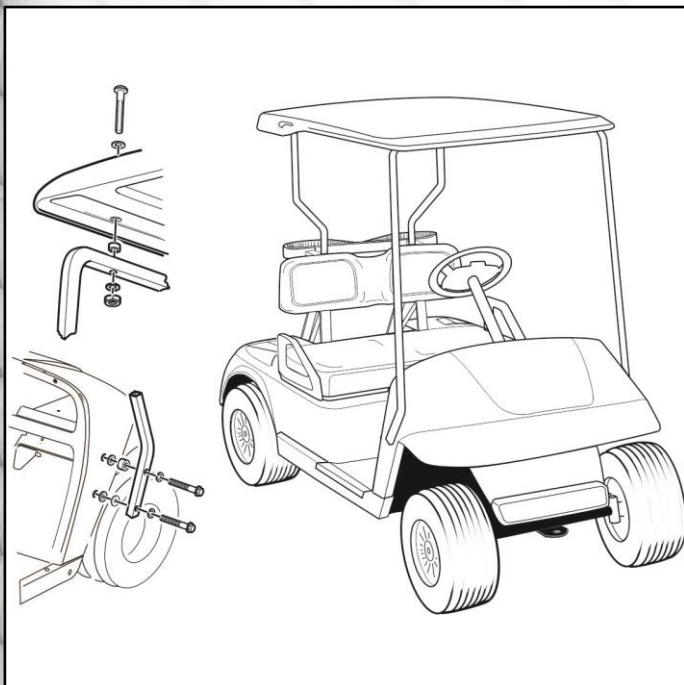

31. Re-attach roof strut, canopy and windshield.

## ALIGNMENT INSTRUCTIONS

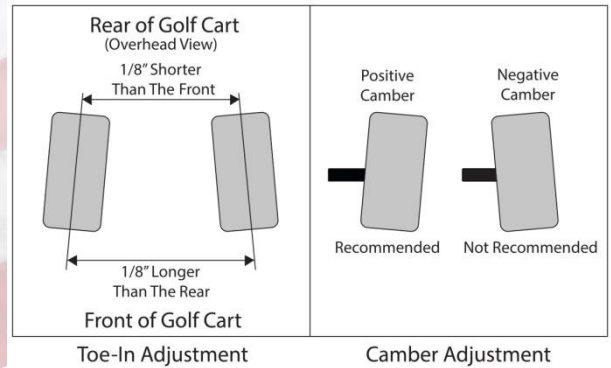
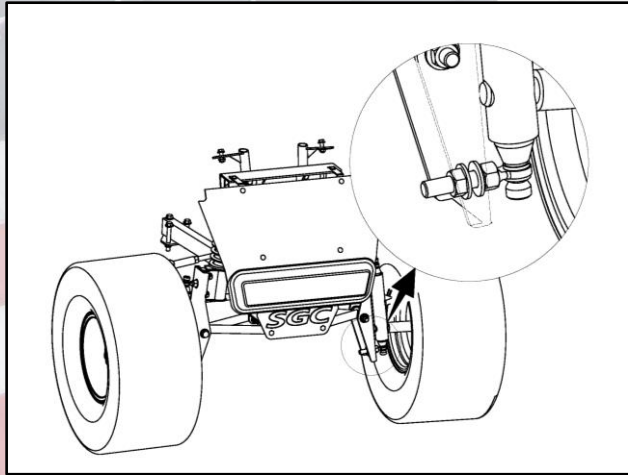

**IMPORTANT:** Both Camber and Toe must be adjusted on this model.

To adjust for proper camber (the vertical tilt of the wheels), use a framing square, level, or some other means of verifying that the tire is at a 90 degree angle to the ground.

Adjust camber to 90 degrees using the two nuts on the bottom heim joint.

If adjusting the camber to 90 degrees is not possible using only the adjustment on the bottom heim joint, then the top heim joint must be disconnected from the spindle, rotated, then reassembled and checked as necessary to achieve the correct camber.

**IMPORTANT:** Be sure to retighten all adjustment points after adjustments are made.

To adjust Toe, ensure the wheels are pointing straight forward. Find a common point to measure from on the inside front and inside rear of the front tires. Adjust until the front measurement is 1/4" to 3/8" greater than the rear measurement. Loosen nut on both tie rod ends. Adjust using a wrench to desired alignment.

If steering wheel is not properly oriented after adjusting toe-out, adjust steering box tie rod to align steering wheel if needed. Loosen tie rod lock nuts and turn steering box tie rod clockwise or counter clockwise to adjust steering wheel.

**IMPORTANT:** Ensure that after this adjustment, both wheels toe out from the cart's centerline equally. Once tightened, roll the cart back 15-20 feet and then forward again to check.

**NOTE:** Be sure to use thread locking adhesive on upper and lower heim joint spindle screws.



