



**SGC DROP AXLE**

**LIFT KIT**

**FITS EZGO WORKHORSE**

**2001.5+**

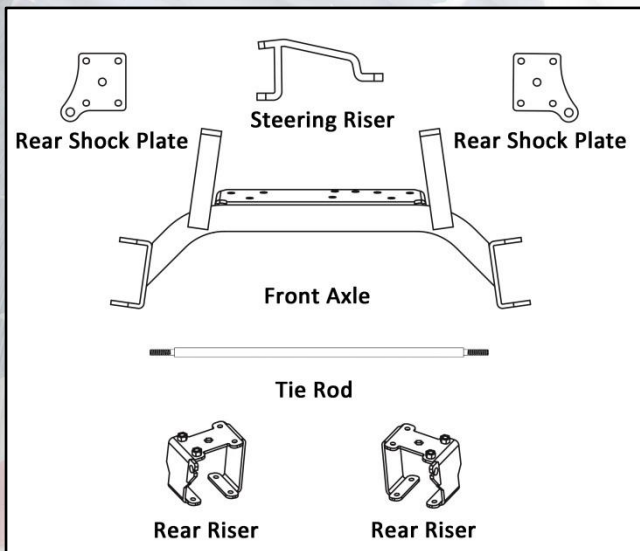

Bag#	Hardware	Spec.	Qty.
F	Hex bolt	7/16*2-1/2	2
	Lock nut	7/16	2
	Flat washer	7/16	4
	Wedged Spacer	12	1
R	Hex bolt	3/8-16*2	4
	Hex bolt	3/8-16*1-1/4	8
	Hex bolt	3/8-16*1-3/4	4
	Lock Nut	3/8	16
	Flat washer	3/8	32

### FRONT INSTALLATION

1. Jack up the front end of the cart and place it on jack stands. You will be installing larger wheels and tires so raise the cart high enough to accommodate for the additional height.
2. Remove the wheels and tires.
3. Remove the tie rod ends from the spindles.
4. Remove the spindles from the front axle. Clean and lubricate these bolts for the reinstallation of the spindles. The two stock mounting holes on the spindle of the passenger side needs drilled out to 1/2" for installation of the steering riser.
5. Remove the front axle from the leaf springs. Clean and lubricate the bolts for installation of the new axle.
6. Using the bolts from the old axle install front axle to the leaf springs.
7. Install the spindles to the new front axle.
8. Install steering riser to the passenger side spindle using the nuts and bolts provided in bag #F.
9. Reattach the tie rod joints to the spindles. **NOTE: SOME E-Z-GO MODEL CARTS COME STOCK WITH A TIE ROD LONG ENOUGH. IF STOCK TIE ROD IS NOT LONG ENOUGH, USE SUPPLIED ONE IN THE KIT.**

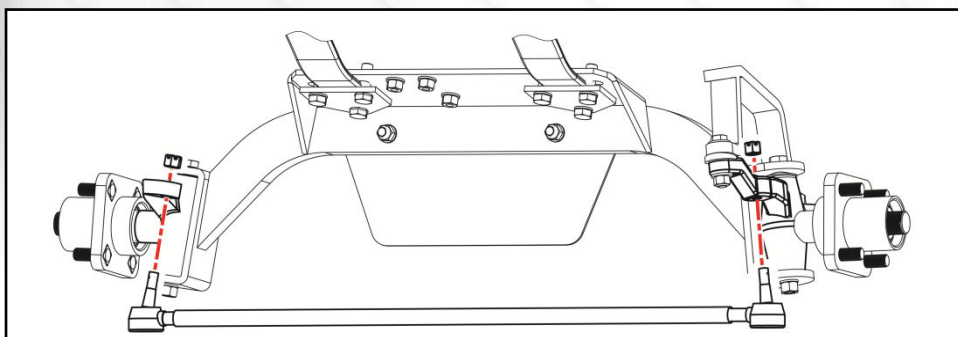
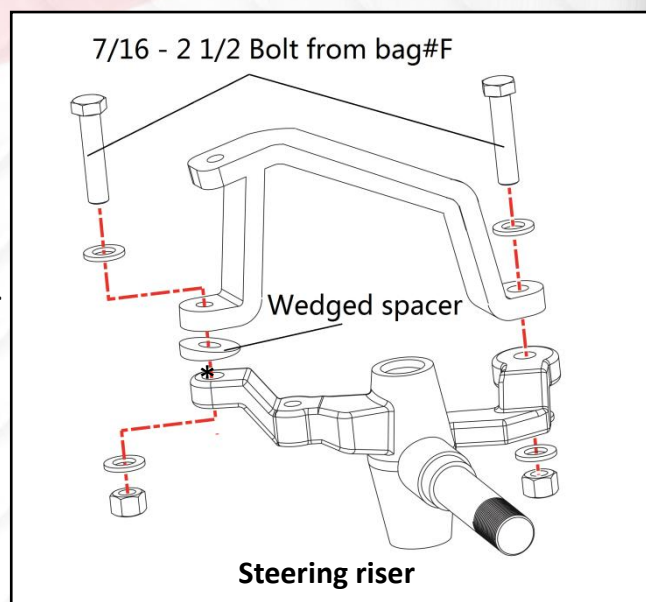

10. Securely tighten all bolts.
  11. Install recommended 22 x 11 x 10 wheels and tires with a 3 x 5" offset for maximum performance and stability. **NOTE: Your stock wheels and tires will NOT work!**
  12. Take the cart off of the jack stands and lower the cart.
  13. Drive the cart forward 10-20 feet and check the toe-in. (Proper toe-in should be approximately 1/8".)
- \* Some models have different spindles on the cart. If your steering riser doesn't sit flush against the steering arm end you will need to install the supplied wedged spacer as shown.

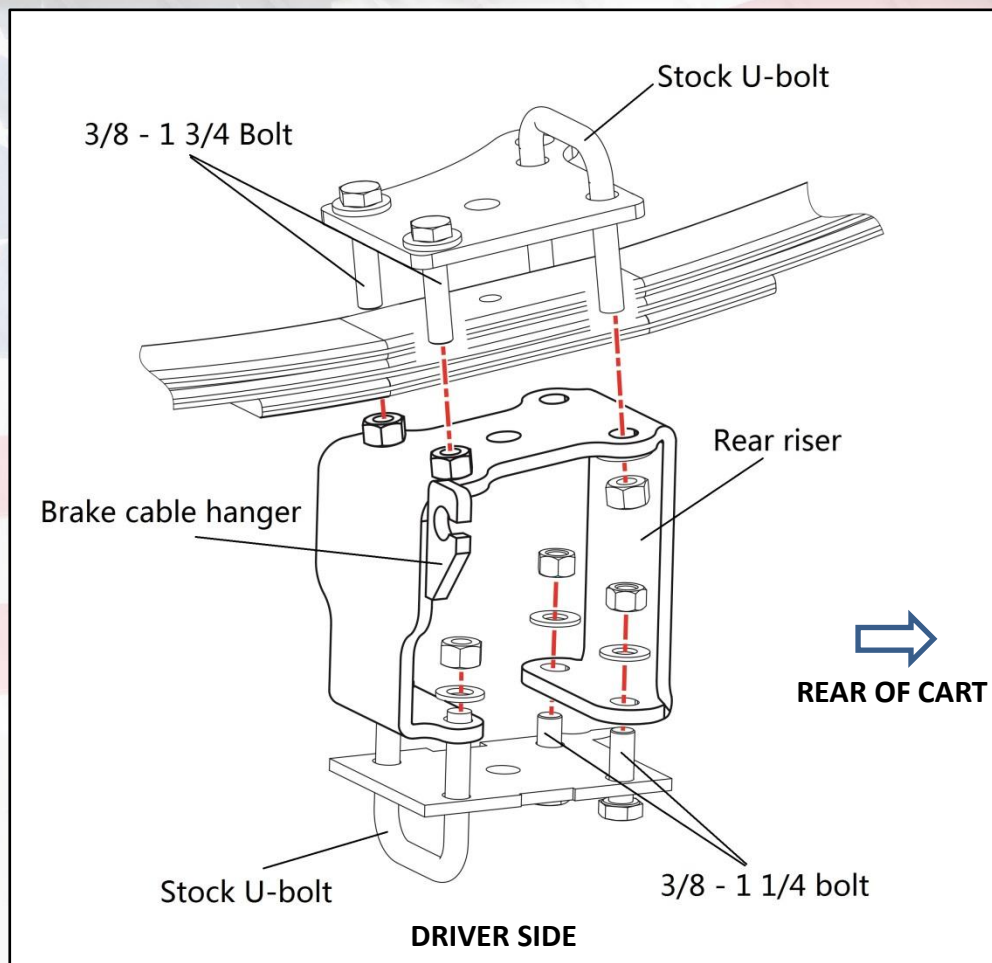

## REAR INSTALLATION

1. Jack up the rear end of the cart and place jack stands on the frame in front of the springs. You will be installing larger wheels and tires so raise the cart high enough to accommodate the additional height.
2. Remove the wheels and tires.
3. Disconnect the rear brake lines from the stock brake mounts and save the clips for reattaching to the new brake hanger. Take the stock brake mounts off the cart and discard. There are new brake hanger on rear risers that you will attach to later.
4. Unbolt the bottom of the shocks. Clean and lubricate these bolts for later use.
5. Unbolt the rear leaf springs. Remove the rubber stopper that is on the top of the rear.
6. Remove the factory brake mounts and save the hardware for reattaching the brake lines to brake hangers that are on the rear lift mounts.
7. The **rear risers** go over the axle with the welded nuts on the top and towards the front of the cart with the brake cable hangers towards the tires. The bottom holes of the risers are to be mounted to the stock holes for the leaf springs using the stock U-bolts for the front and the supplied 3/8" X 1 1/4" nuts and bolts.
8. Place the leaf springs on top of the risers.
9. Place **rear shock plates** on top of the leaf springs with the shock mount holes facing the rear of the cart and towards the center. Using the supplied 3/8" X 1 3/4" bolts mount the front of the shock plates to the welded on nuts of the rear spring risers with the leaf springs sandwiched in between. Using the stock U-bolts from the leaf springs mount the rear of the shock plates to the rear risers. Make sure you tighten these bolts evenly. Extra bolts are provided if stock U bolt is unusable.
10. Attach the bottom of the shocks to new rear shock plates using the stock nuts and bolts.
11. Reattach the brake lines to brake mounts with the saved factory clip. Re-adjust the brakes if needed.
12. Double check all nuts, bolts and cables for tightness.
13. Install recommended wheel and tire size 22 x 11 x 10 wheels and tires with a 3 x 5" offset for maximum performance. **NOTE:** Your stock wheels and tires will NOT work!



## RETURN MERCHANDISE AUTHORIZATION

Dear Valued Customer,

Thank you for choosing Steeleng Golf Cart Accessories for your golf cart needs.

We apologize for the issues you are having with your purchase. We strive to offer the absolute best quality at the absolute best price.

To best serve you, we do need a little information to help process your return and/or exchange faster.

Please complete the following and include this entire form with your return.

\_\_\_\_\_  
Name

\_\_\_\_\_  
Shipped To Address

\_\_\_\_\_  
STATE

\_\_\_\_\_  
ZIP

Purchased with:                      eBay                      Direct Phone Order

This is for              EXCHANGE              REFUND

Please describe reason for return:-

\_\_\_\_\_

\_\_\_\_\_

\_\_\_\_\_

\_\_\_\_\_

Our Return Address:  
Steeleng Golf Cart Accessories  
3309 Laurens Road,  
Greenville, SC 29607  
Tele: 864-675-1103

For Office Use Only:

Received By: \_\_\_\_\_                      Date \_\_\_\_\_

Refund Amount \_\_\_\_\_                      Exchange Issued \_\_\_\_\_

\*\*Steeleng Golf Cart Accessories reserves the right to charge a 15% restocking fee for all returned and/or exchanged items.